

Victaulic PGS-300 Cut Groove Specifications

1.0 DIMENSIONS

For Schedule 40 or Schedule 80 CPVC and PVC plastic pipe¹⁻²

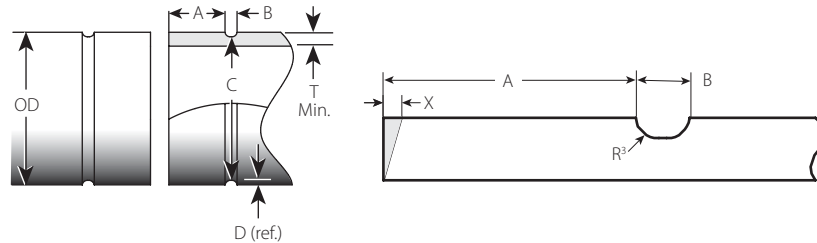

Exaggerated for Clarity

1	2			3	4	5		6	7	8
Nominal inches DN	Size Actual Outside Diameter			Gasket Seat A ±0.015 ±0.38 inches mm	Groove Width B ±0.005 ±0.13 inches mm	Groove Diameter C		Groove Depth D (ref) inches mm	Pipe End Chamfer X Maximum inches mm	Thickness T inches mm
	Basic inches mm	Maximum inches mm	Minimum inches mm			Maximum inches mm	Minimum inches mm			
	2 DN50	2.375 60.3	2.381 60.48			2.369 60.17	0.875 22.23			
2 ½	2.875 73.0	2.882 73.20	2.868 72.85	0.875 22.23	0.188 4.76	2.695 68.45	2.677 68.00	0.09 2.3	0.094 2.39	0.203 5.16
3 DN80	3.500 88.9	3.508 89.10	3.492 88.70	0.875 22.23	0.188 4.76	3.320 84.33	3.302 83.87	0.09 2.3	0.094 2.39	0.216 5.49
4 DN100	4.500 114.3	4.509 114.53	4.491 114.07	0.875 22.23	0.188 4.76	4.320 109.73	4.300 109.22	0.09 2.3	0.094 2.39	0.237 6.02
6 DN150	6.625 168.3	6.636 168.55	6.614 168.00	1.000 25.40	0.250 6.35	6.345 161.16	6.323 160.60	0.14 3.6	0.125 3.18	0.280 7.11
8 DN200	8.625 219.1	8.640 219.46	8.610 218.69	1.000 25.40	0.250 6.35	8.305 210.95	8.280 210.31	0.16 4.1	0.125 3.18	0.322 8.18
10 DN250	10.750 273.0	10.765 273.43	10.735 272.67	1.000 25.40	0.250 6.35	10.430 264.92	10.403 264.24	0.16 4.1	0.188 4.78	0.365 9.27
12 DN300	12.750 323.9	12.765 324.23	12.735 323.47	1.000 25.40	0.250 6.35	12.390 314.71	12.360 313.94	0.18 4.6	0.188 4.78	0.406 10.31

NOTES

- COLUMN 1 – Nominal NPS pipe size.
 - COLUMN 2 – Outside diameter. The outside diameter of cut grooved pipe shall not vary more than the limits listed. The maximum allowable tolerance from square cut ends is 0.032"/0.8 mm.
 - COLUMN 3 – Gasket seat. The pipe surface shall be free from indentations and projections from the end of the pipe to the groove to provide a leaktight seat for the gasket. All loose paint, dirt, chips and grease must be removed.
 - COLUMN 4 – Groove width. Bottom of groove to be free of loose dirt and chips that may interfere with proper coupling assembly.
 - COLUMN 5 – Groove diameter. The groove must be uniform depth for the entire pipe circumference. Groove must be maintained within "C" diameter limits listed.
 - COLUMN 6 – Groove depth. For reference only. GROOVE MUST CONFORM TO "C" DIAMETER SHOWN.
 - COLUMN 7 – It is acceptable to groove and join pipe with chamfers. Pipe end chamfers greater than those listed are not recommended for use with Victaulic grooved mechanical couplings and must be removed prior to grooving the pipe.
 - COLUMN 8 – Minimum allowable wall thickness. The minimum nominal wall thickness which may be cut grooved.
- ¹ Schedule 80 chlorinated polyvinyl chloride (CPVC) pipe per ASTM F441, 23447 minimum cell classification per ASTM D1784.
² Polyvinyl chloride (PVC) pipe per ASTM D1785, 12454 minimum cell classification per ASTM D1784.
³ Groove radius "R". The radius necessary at the bottom of the groove.

System No.		Location	
Submitted By		Date	

Spec Section		Paragraph	
Approved		Date	

2.0 GROOVING

CG1100 Cut Grooving Tool

For pipe size and wall thickness capacity for this light weight, portable field or shop fabrication tool, reference [publication 24.09](#).

VG Vic-Groover

For pipe size and wall thickness capacity for this in-place manual cut grooving tool, reference [publication 24.01](#).

3.0 REFERENCE MATERIALS

[24.01: Victaulic Pipe Preparation Tools](#)

[24.09: Victaulic Cut Grooving Tool for CPVC/PVC Pipe Model CG1100](#)

[33.03: Victaulic CPVC Fittings](#)

[33.06: Victaulic Installation-Ready™ Transition Coupling Style 356](#)

[33.07: Victaulic Installation-Ready™ Rigid Coupling Style 357](#)

[33.08: Victaulic Reducing Coupling Style 358](#)

[33.16: Victaulic Installation-Ready™ Transition Coupling for CPVC/PVC Pipe in Potable Water Applications Style 856](#)

[33.17: Victaulic Installation-Ready™ Rigid Coupling for CPVC/PVC Pipe in Potable Water Applications Style 857](#)

[33.18: Victaulic Reducing Coupling for CPVC/PVC Pipe in Potable Water Applications Style 858](#)

ALWAYS REFER TO ANY NOTIFICATIONS AT THE END OF THIS DOCUMENT REGARDING PRODUCT INSTALLATION, MAINTENANCE OR SUPPORT.

User Responsibility for Product Selection and Suitability

Each user bears final responsibility for making a determination as to the suitability of Victaulic products for a particular end-use application, in accordance with industry standards and project specifications, and the applicable building codes and related regulations as well as Victaulic performance, maintenance, safety, and warning instructions. Nothing in this or any other document, nor any verbal recommendation, advice, or opinion from any Victaulic employee, shall be deemed to alter, vary, supersede, or waive any provision of Victaulic Company's standard conditions of sale, installation guide, or this disclaimer.

Intellectual Property Rights

No statement contained herein concerning a possible or suggested use of any material, product, service, or design is intended, or should be construed, to grant any license under any patent or other intellectual property right of Victaulic or any of its subsidiaries or affiliates covering such use or design, or as a recommendation for the use of such material, product, service, or design in the infringement of any patent or other intellectual property right. The terms "Patented" or "Patent Pending" refer to design or utility patents or patent applications for articles and/or methods of use in the United States and/or other countries.

Note

This product shall be manufactured by Victaulic or to Victaulic specifications. All products to be installed in accordance with current Victaulic installation/assembly instructions. Victaulic reserves the right to change product specifications, designs and standard equipment without notice and without incurring obligations.

Installation

Reference should always be made to the Victaulic installation handbook or installation instructions of the product you are installing. Handbooks are included with each shipment of Victaulic products, providing complete installation and assembly data, and are available in PDF format on our website at www.victaulic.com.

Warranty

Refer to the Warranty section of the current Price List or contact Victaulic for details.

Trademarks

Victaulic and all other Victaulic marks are the trademarks or registered trademarks of Victaulic Company, and/or its affiliated entities, in the U.S. and/or other countries.